

CLIM8ZONE™



Information Guide

*spaTouch*3*

Your Single Source Solution

THANK YOU

for using Balboa Water Group spa controls.

Please visit us at
www.BalboaWaterGroup.com





TEMPERATURE MODES

CLIM8ZONE™ has four Temperature modes for heating/cooling spa water.

- 1 **HEATING MODE** *(Default)*
This mode only heats the spa water. All cooling with the CLIM8ZONE™ unit is disabled.
- 2 **COOLING MODE**
This mode only cools the spa water. All heating with the CLIM8ZONE™ unit is disabled.
- 3 **HEATING AND COOLING MODE** *(Default)*
This mode heats and cools the spa water with the CLIM8ZONE™ unit enabled.
- 4 **DISABLED**



eHeater MODES

The BP control system has three eHeater modes.

- 1 **CONTINUOUS**
The electric heater (eHeater) is continuously enabled.
- 2 **eBOOST** *(Default)*
The electric heater is enabled temporarily when an extra boost is required.
- 3 **DISABLED**



SPEED MODES

CLIM8ZONE™ has three Speed modes.

- 1 **AUTO SMART** *(Default)*
 - For Heating or Cooling
 - Uses Artificial Intelligence
 - Variable Heating/Cooling capacity
 - The CLIM8ZONE™ computer automatically adjusts the compressor frequency up or down using an algorithm that is based on ambient air temperature and water temperature.
 - This algorithm balances a best case in most conditions for efficiency and noise vs heating/cooling output of the CLIM8ZONE unit.
- 2 **MANUAL HIGH**
 - For Heating or Cooling
 - Highest Heating Capacity
 - Fastest Water Heating/Cooling
 - Low COP (i.e. Low Energy Efficiency)
 - High Compressor Frequency – Fixed, i.e. does not adjust based on environmental conditions
 - The CLIM8ZONE unit Compressor Noise is Maximum
- 3 **MANUAL LOW**
 - For Heating or Cooling
 - Lowest Heating/Cooling Capacity
 - Slowest Water Heating
 - High COP (i.e. High Energy Efficiency)
 - Low Compressor Frequency – Fixed, i.e. does not adjust based on environmental conditions
 - The CLIM8ZONE unit Compressor Noise is Minimum

PANEL

spaTouch™ 3



spaTouch™ 3

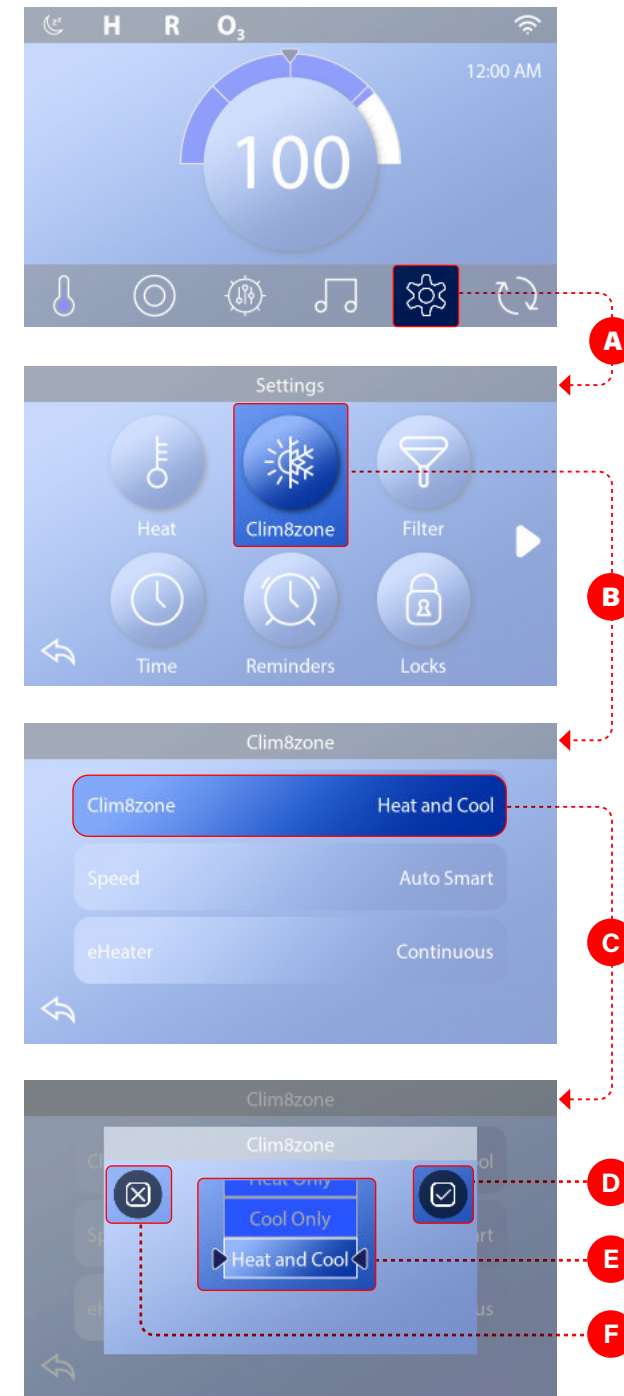

SET THE TEMPERATURE MODE

Follow these steps to set the Temperature mode.

1 - Press the Settings button (A) to enter the Settings screen.

2 - Press the CLIM8ZONE™ button (B) to enter the CLIM8ZONE™ screen.

3 - Press the CLIM8ZONE™ button (C) to enter the CLIM8ZONE™ screen.

4 - Select one of the following Temperature modes (E):

Heat Only (Default)

Cool Only

Heat and Cool

Disabled

5 - Press the Save button (D) to save your setting. Press the Cancel button (F) to cancel your setting.

Your setting is complete. ☒

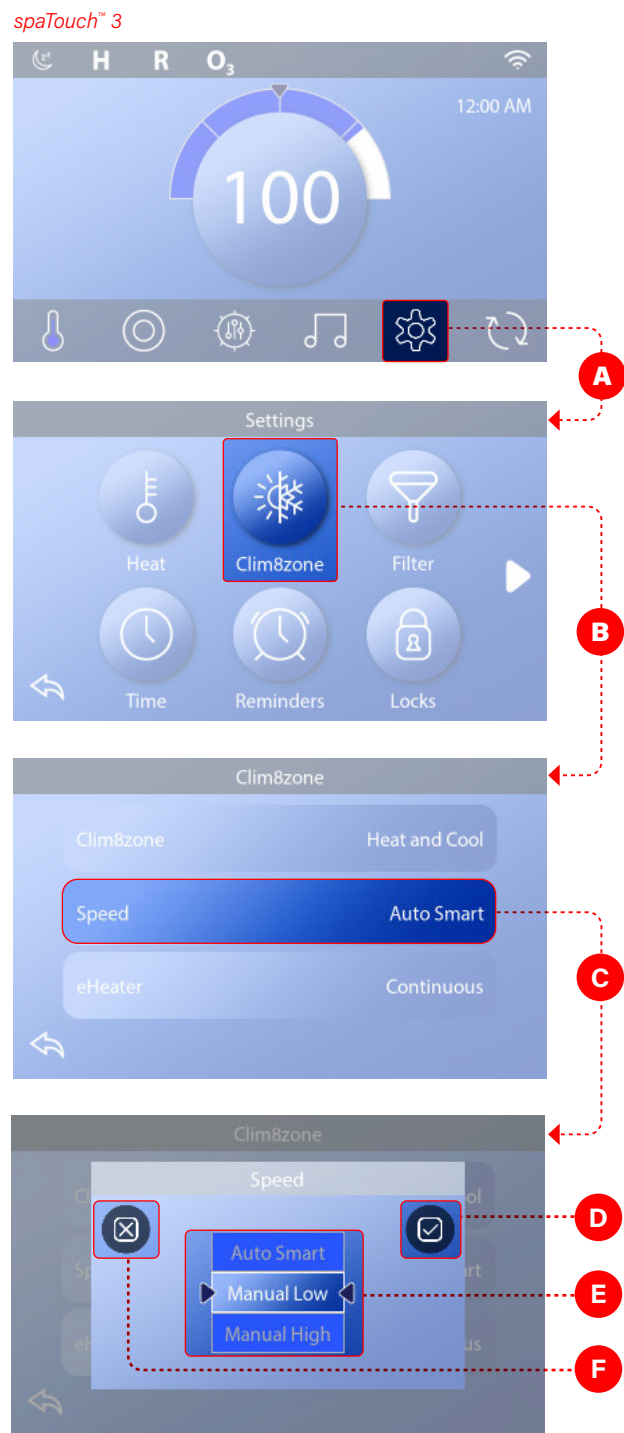

SET THE SPEED MODE

Follow these steps to set the Temperature mode.

1 - Press the Settings button (A) to enter the Settings screen.

2 - Press the CLIM8ZONE™ button (B) to enter the CLIM8ZONE™ screen.

3 - Press the Speed button (C) to enter the Speed screen.

4 - Select one of the following Speed modes (E):

Manual High

Auto Smart (Default)

Manual Low

5 - Press the Save button (D) to save your setting. Press the Cancel button (F) to cancel your setting.

Your setting is complete. ☒

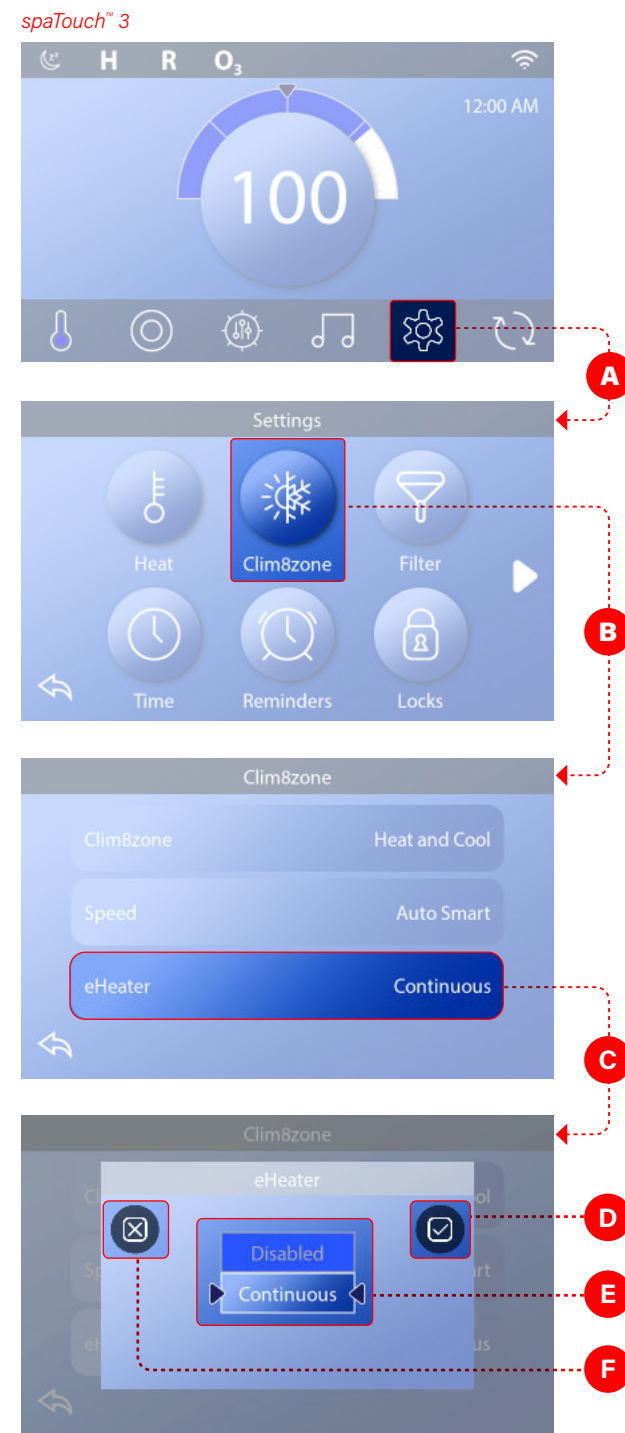

SET THE eHEATER MODE

Follow these steps to set the eHeater mode.

1 - Press the Settings button (A) to enter the Settings screen.

2 - Press the CLIM8ZONE™ button (B) to enter the CLIM8ZONE™ screen.

3 - Press the eHeater button (C) to enter the eHeater screen.

4 - Select one of the following eHeater modes (E):

Disabled

Continuous

eBOOST (Default)

5 - Press the Save button (D) to save the new setting. Press the Cancel button (F) to cancel the setting change.

Your setting is complete. ☒



CLIM8ZONE™

Email

info@balboawater.com

Phone

P : + 714.384.0384
Customer Service is available:
M - F 7:00AM to 6:00PM PT

Corporate Office

Balboa Water Group
3030 Airway Avenue
Costa Mesa, CA 92626

MEXICO OPERATIONS

Balboa Water Group
Aguila Azteca 6011
Baja Maq. El Aguila
Mexico 22221

EUROPEAN OPERATIONS

Balboa Water Group
Hydroair International
ApS Roustvej 50 DK-6800
Varde